

HINGE-FRONT INDUSTRIAL PROCESS GAUGE

PRESSURE GAUGES

Reotemp's Series PI45 process gauge is designed to withstand corrosive atmospheres and media, ideal for panel builders in the heavy-industrial markets. The hinge-front case allows for easy access to the gauge dial while still panel mounted.



PI



Dials



Accuracy



Custom Logo



Diaphragm Seal
Compatible

FEATURES / BENEFITS

- All Stainless Steel Internal Parts
- Internal Overload and Underload Stops
- Micro-Adjustable Pointer with Floating Zero
- Hinge-Front Case for Easy Recalibration



SPECIFICATIONS

Accuracy	±0.5%, ASME Grade 2A, (10k-20k psi, 1% upscale and 3% downscale)
Ambient Limits	-40°F/150°F
Process Limits	-40°F/250°F
Process Limits with Diaphragm Seal	-60°F/400°F (Direct Mount)* -110°F/750°F (Remote Mount or Cooling Tower)* *Exact limits depend on diaphragm seal and fill fluids.
Wetted Materials	Tube: 316SS Seamless Socket: 316SS
Lens	Glass (Standard on 6") Plastic (Standard on 4.5")
Other Materials	Case: Black Painted Aluminum Ring: Black Painted Aluminum Dial: Aluminum Case-to-Socket: O-Ring, Vented
Fillable	No
Restrictor Screw	Yes
Maximum Working Pressure	Stable = 100% Momentary = 130% of scale
Weight	2.5 lbs

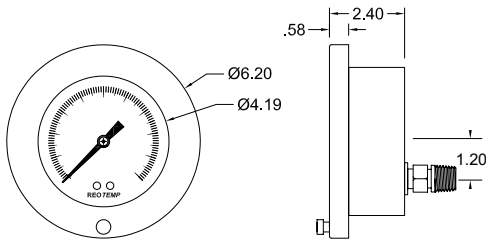

PI45

*dimensions in inches

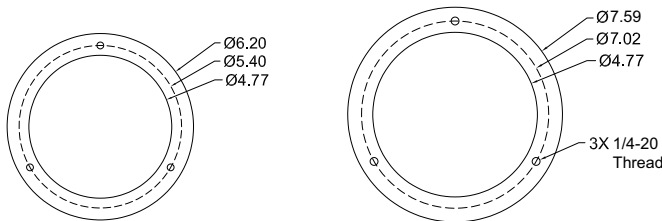

Integrated PI45 Mounting Flange

Integrated PI60 Mounting Flange

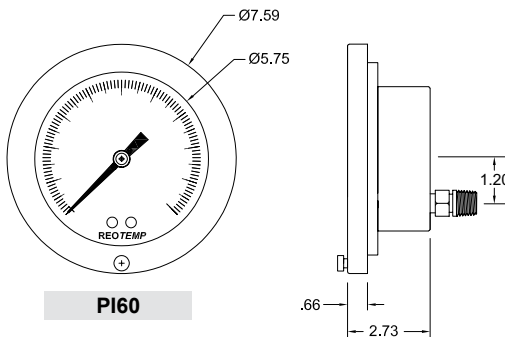

PI60

*dimensions in inches

HINGE-FRONT INDUSTRIAL PROCESS GAUGE



Visit reotemp.com

- ✓ Check Stock
- ✓ Get Price
- ✓ Configure Part #
- ✓ Download PDF Data Sheets

HOW TO ORDER: Choose options to build a part number. For example: **PI45H1E2P16-D-P-HV**

PI45	H	1	E	2	P16	-D	-P	-HV
DIAL SIZE	CASE TYPE	TUBE & SOCKET	MOUNT TYPE	CONNECTION	RANGE CODE	CASE FILL	LENS	OPTIONS
PI45 = 4.5" *PI60 = 6"	H = Black Painted Aluminum, Hinge- Front	1 = 316SS *3 = Monel	E = Lower Back/Front Flange Bottom Mount/Front Flange G = Lower Back/Front Flange Bottom Mount/Front Flange	2 = 1/2" NPT 4 = 1/4" NPT	N06B = Vac to 0 to 150 psi/Ammonia N08 = Vac to 0 to 300psi/ Ammonia N06 = Vac to 0 to 160psi/ Ammonia N09 = Vac to 0 to 400psi/ Ammonia <i>Other Refrigerant Ranges Available: R404A, R22, R410A, R134A</i>	-D = Dry <i>Case is not fillable.</i>	-P = Plastic -G = Glass	-HV = Hi-Vis™ Dial -C3 = 3 pt. Calibration Certificate -OX = Cleaned for O ₂ Service -NC = NACE Compliance Certificate -PM = Positive Material Identification Certification

*Non-standard configuration

Diaphragm Seal Suitability Guide

For applications where a diaphragm seal is required, the following diaphragm seal model types are most commonly assembled and filled to Series PI45 pressure gauges. This matrix identifies which diaphragm seal is appropriate based on the specified pressure range. Please reference the diaphragm seal data sheet and seal fill fluid guide for additional application considerations including max pressure, temperature limits, and material compatibility.

Diaphragm Seal Model

Total Gauge Span* (in psi)

Mini Seals



	15	30	45	60	75	100	160+
MS6	X	S	T	T	T		
MS8	S	T	T				

Threaded Flush



	15	30	45	60	75	100	160+
1"	X	X	X	S	S	T	
1.5"	S	S	T	T			

Offline



	15	30	45	60	75	100	160+
W5	S	T	T				
W6	T						
T5	S	T					
W7/V5							

*Total gauge span is additive of negative and positive pressures.

Example: -15 - 0 - 30 psi = 45 psi span

- Assembly will function correctly with minimal accuracy degradation.
- T Assembly will function correctly given stable temperature.
Assembly is highly sensitive to orientation and temperature variance. Reotemp cannot guarantee a stated accuracy.
- S Assembly is highly sensitive to orientation and temperature variance. Reotemp cannot guarantee a stated accuracy.
- X Assembly will not work. The diaphragm does not displace enough fill fluid to drive the pressure gauge.